



W I N T E C H

An Employee Owned Company



**H210 HANG-ON
LOUVER INSTALLATION
INSTRUCTIONS**



W I N T E C H
An Employee Owned Company

H210 Hang-On Louver Installation Instructions

Table of Contents

General Overview & Information.....	3
Cleaning	3
Construction Notes	3
H210 Hang-On Installation Instructions	5



WINTECH
An Employee Owned Company

H210 Hang-On Louver Installation Instructions

I. General Overview and Information

A. Handling and Storage

1. Handle all louvers and other material carefully
2. Do not drop, drag, or walk on boxed or crated material.
3. Place protective spacers between each louver, louver and wall, and louver and floor during storage.
4. Store louvers off the ground on pallets, planks or similar materials. Louvers stored outside must be protected from rain, snow, etc.
5. Protect louvers from other trade damage or manufacturing processes with ventilated covering.
6. Remove material from packaging if it becomes wet. Repack materials and move to a dry location.

B. Window and Material Inspection

1. Inspect all louvers and other material upon delivery for damage and quantity accuracy. Report damage and / or missing material to WinTech and freight carrier immediately.

II. Cleaning

A. Cleaning Window Units

1. Plaster, cement, terrazzo, alkaline, and acid based materials used to clean masonry are very harmful to painted and anodized finishes and should be removed with water and mild soap immediately, to prevent permanent staining. Spot testing is recommended prior to any cleaning agent being applied to the doors.
2. Cleaning of painted aluminum surfaces should be performed in accordance with American Architectural Manufacturing Association (AAMA) 609 and 610-02 "Cleaning and Maintenance Guide for Architecturally Finished Aluminum".
3. Cleaning of anodized aluminum surfaces should be performed in accordance with American Architectural Manufacturing Association (AAMA) 609 and 610-02 "Cleaning and Maintenance Guide for Architecturally Finished Aluminum".
4. If protective coatings are required, they must be removed from any area of the window unit that requires field applied sealant prior the installation of the louver.

III. Construction Notes

A. Reference Project Documents

1. Check any shop drawings, elevation drawings, project specific details, and installation instructions to become thoroughly familiar with the project. Any project specific documents, such as shop drawings, details, etc., take precedence over these installation instructions.

B. Opening Verification

1. Ensure that construction that will receive WinTech louver is in accordance with the contract documents. If construction is not per the contract documents please notify the general contractor in writing and resolve differences prior to proceeding with work.



WINTECH
An Employee Owned Company

H210 Hang-On Louver Installation Instructions

2. The opening must be verified to confirm it is square, level, and plumb and has the proper clearance for the designated louver.

C. Isolate Aluminum

1. Aluminum that is in direct contact with masonry or incompatible materials must be isolated with a heavy coat of zinc chromate, plastic isolators, or bituminous paint.

D. Sealant

1. All sealant used must be compatible with all the materials it contacts, including other sealant. All sealant unless noted is not by WinTech and is to be supplied by others.
2. WinTech does not recommend sealant or caulking types and will not assume liability or responsibility of sealant or caulking not supplied by WinTech. The sealant supplier should be consulted for sealant recommendations associated with compatibility, adhesion, priming, tooling, shelf life, and joint design. It is the sole responsibility of the customer to perform all sealant adhesion and compatibility testing that is required by the sealant manufacturer of choice for sealant that is to be supplied by the customer.

E. Safety

1. Follow all required safety and PPE procedures when installing louvers and PTAC sleeves and other aluminum fenestration products provided by WinTech.



WINTECH
An Employee Owned Company

H210 Hang-On Louver Installation Instructions

IV. Hang-On Louver Installation Instructions

A. Louver Installation

1. Measure wall opening to ensure opening is large enough for selected manufacturer PTAC sleeve to fit.
2. Insert the PTAC sleeve into the wall opening and secure per PTAC manufactures recommendation.
 - *PTAC sleeve should protrude past the exterior face of the exterior wall a minimum of 5/8" or per the PTAC sleeve manufacturer's guidelines. See Figure 1.*
3. Once the PTAC sleeve is placed and secured in the correct location a continuous sealant joint should be applied between the PTAC sleeve and the wall condition to ensure a water tight joint. See Figure 2.

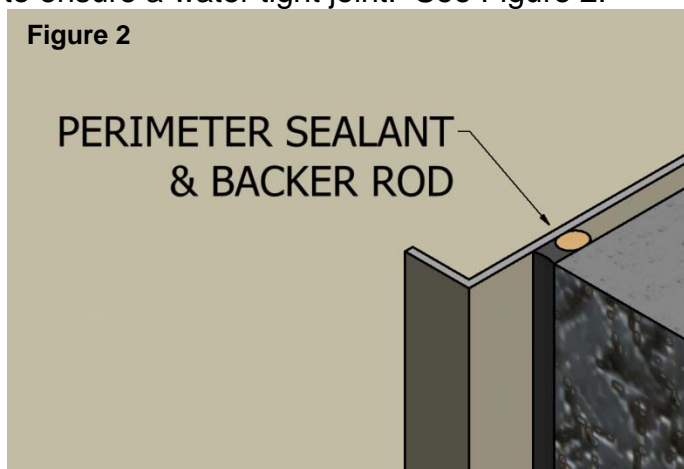
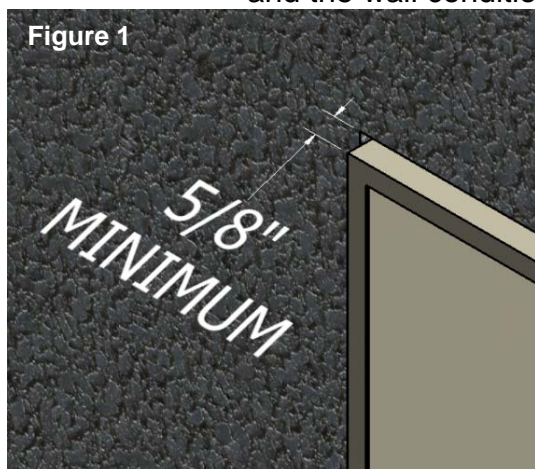

4. Inspect louver and remove any dirt, debris, or other objects that may impede PTAC sleeve installation or free air movement.
5. Install any foam baffles and diffuser grills required by the PTAC manufacturer to the WinTech louver.
6. Remove the hex nut from all threaded studs on the louver. See Figure 3.
 - *Do not lose hex nut, store in a safe place!*

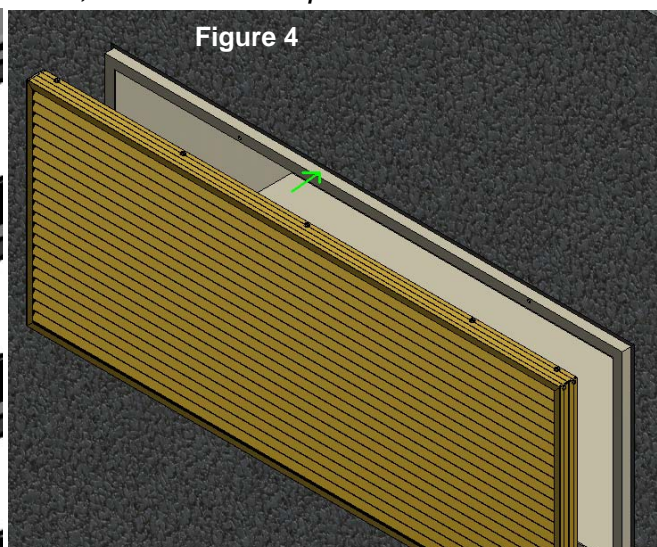
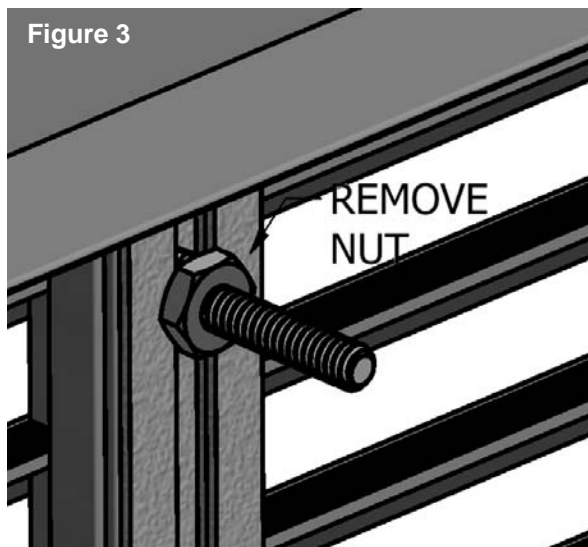



WINTECH
An Employee Owned Company

H210 Hang-On Louver Installation Instructions

7. Place H210 Hang-On Louver onto PTAC sleeve. The threaded studs on the hang-on louver should align with the attachment holes on the PTAC sleeve. See Figure 4.
 - *If threaded studs need adjustment, remove louver and slide studs to correct location.*
8. Apply hex nuts removed from threaded studs in step 6 back to threaded studs. Tighten nuts completely to ensure the hang-on louver is securely fastened to the PTAC sleeve.

B. Special Circumstance

1. In the event any hang-on louver is wider than standard width of 43-3/8", additional perimeter anchorage to the building condition may be required.
 - *Perimeter anchorage design and application varies per project based on design loads, PTAC sleeve offsets, and building condition type.*