

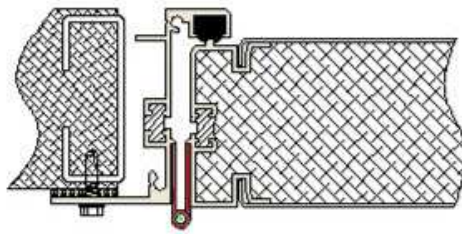

Standard Door: Consists of hinged / swinging door with factory prepped and locking hardware. This door is used where frequent access is required. See *1* and *2* detail and elevation locations for clarification.



1

Hinging Hardware on one side of door leaf

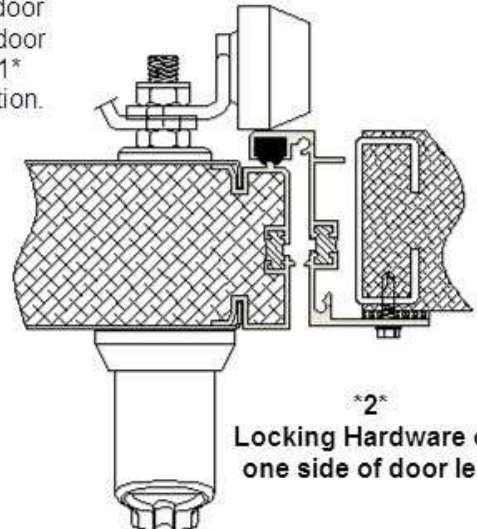

2

Locking Hardware on one side of door leaf

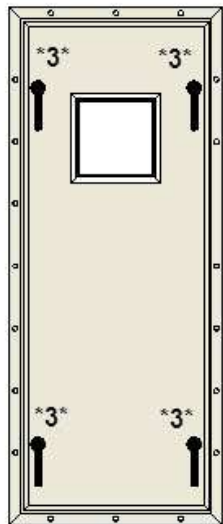

Plug Door: Consists of locking hardware on both sides of door with no hinges.



3

Locking hardware on both sides of door leaf - No Hinges. See elevation for clarification.

Plug Door: Used where door must be completely removable or when door is large enough to make hinging impractical.

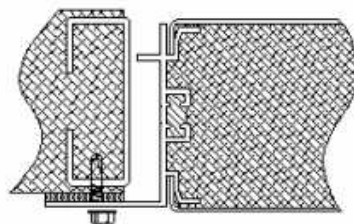
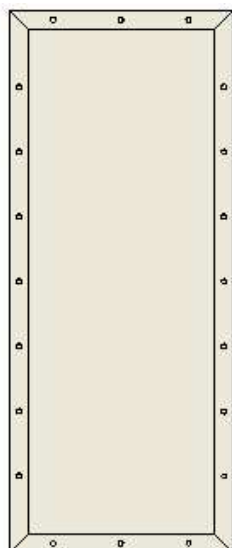
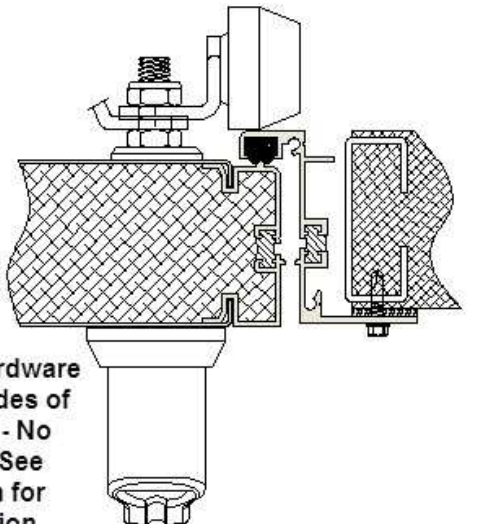

Fixed Access Panel: Consists of door frame only and has no locking hardware or hinges. Door is permanently attached to Air Handler with anchor screws.

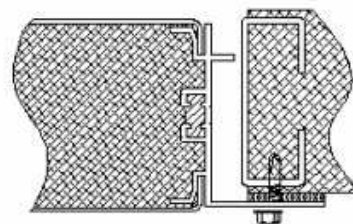

Fixed Access Panel: Used in applications when only occasional access is required (by removing anchor screws from frame to air handler).