

CR70 VINYL SLIDER PERFORMANCE DATA: AAMA/WDMA/CSA 101/I.S.2/A440-11

Rating	LC-PG30
Air Infiltration	0.01 cfm/ft @ 1.62 psf
Water Resistance	0 Leakage @ 4.59 lb/sf
Structural Performance	45.1 psf
Frame Depth	2-3/4"
Infill Options	Maximum 3/4"
U-Values	.28 (Low E and Argon)

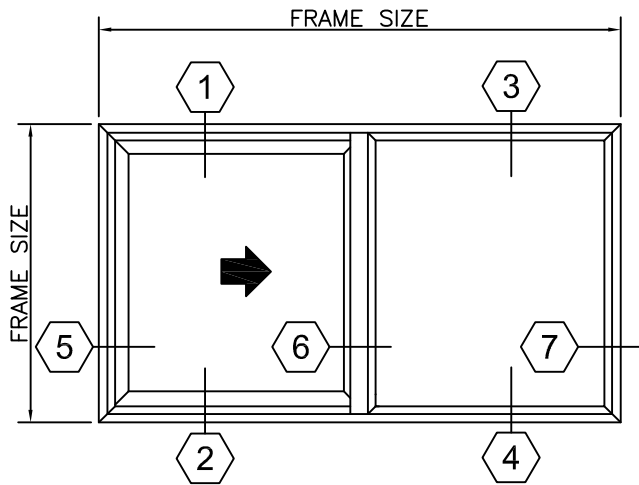

TYPE:	QTY:
S70	ARCH MK:
PRODUCT:	
XO SLIDER	

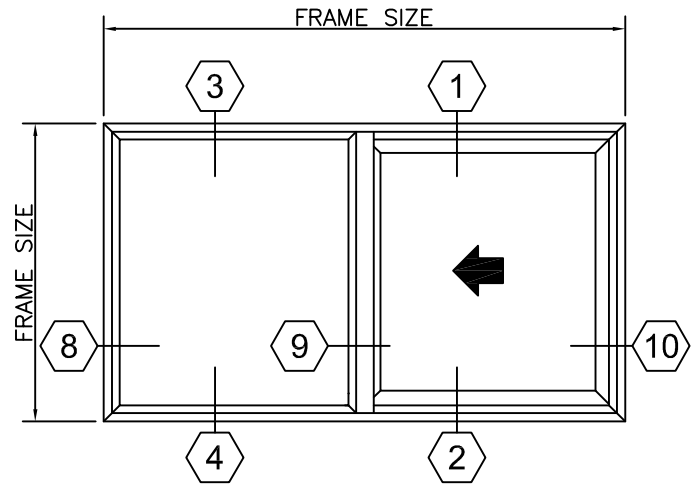

TYPE:	QTY:
S70	ARCH MK:
PRODUCT:	
OX SLIDER	

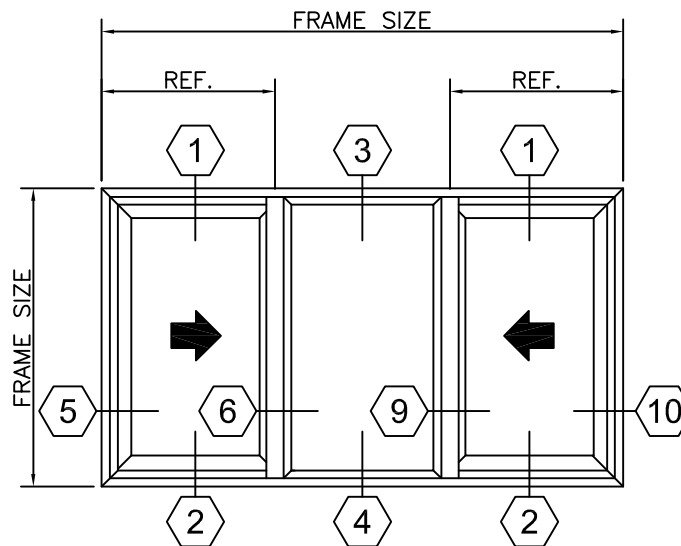

TYPE:	QTY:
S70	ARCH MK:
PRODUCT:	
XO SLIDER	

FULL SCALE DETAILS

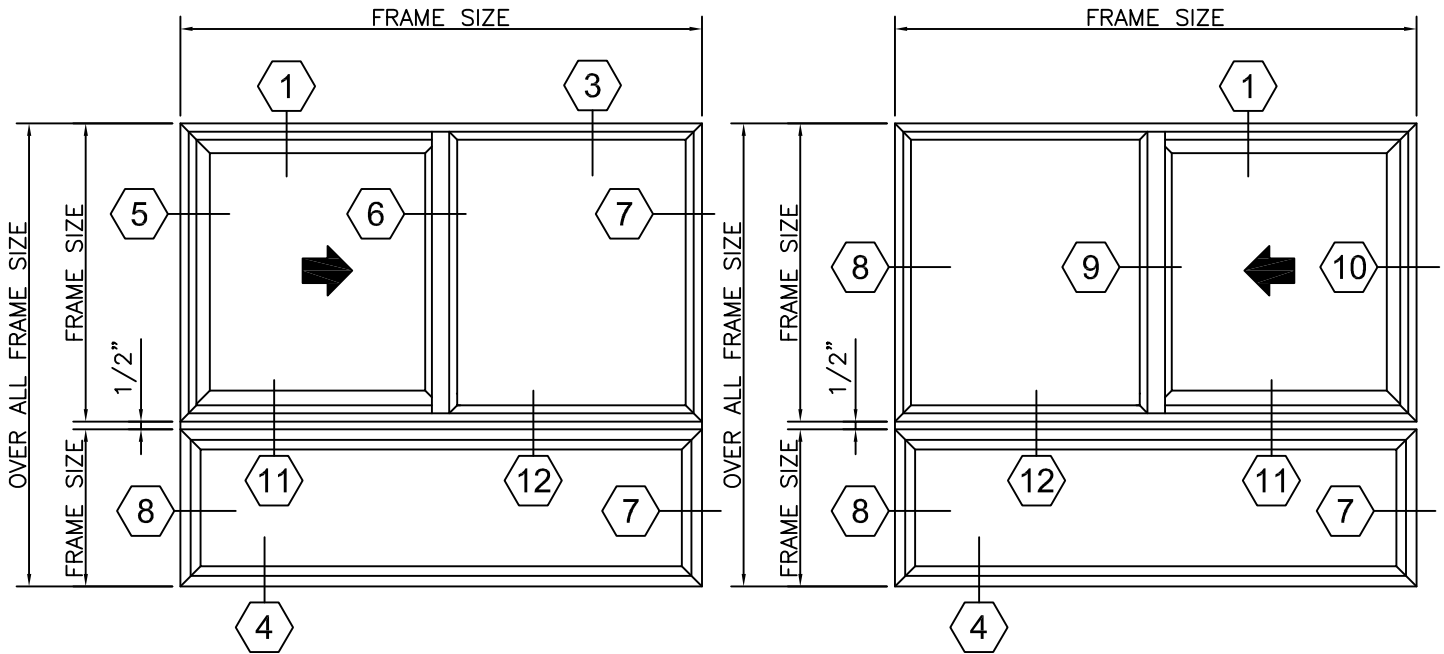

TYPE: S70	QTY:
ARCH MK:	
PRODUCT: XO SLIDER FIXED VINYL	

TYPE: S70	QTY:
ARCH MK:	
PRODUCT: OX SLIDER FIXED VINYL	

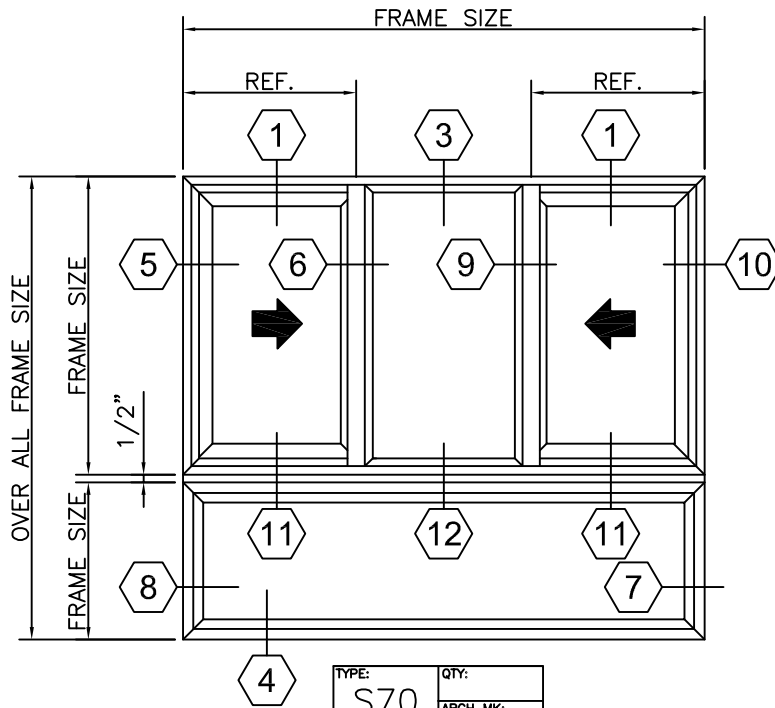

TYPE: S70	QTY:
ARCH MK:	
PRODUCT: XO SLIDER FIXED VINYL	

FULL SCALE DETAILS

WINTECH

P.O. BOX 480
MONETT, MO 65708-0480

P: 417-235-7821
F: 417-737-7140
www.wintechinc.com

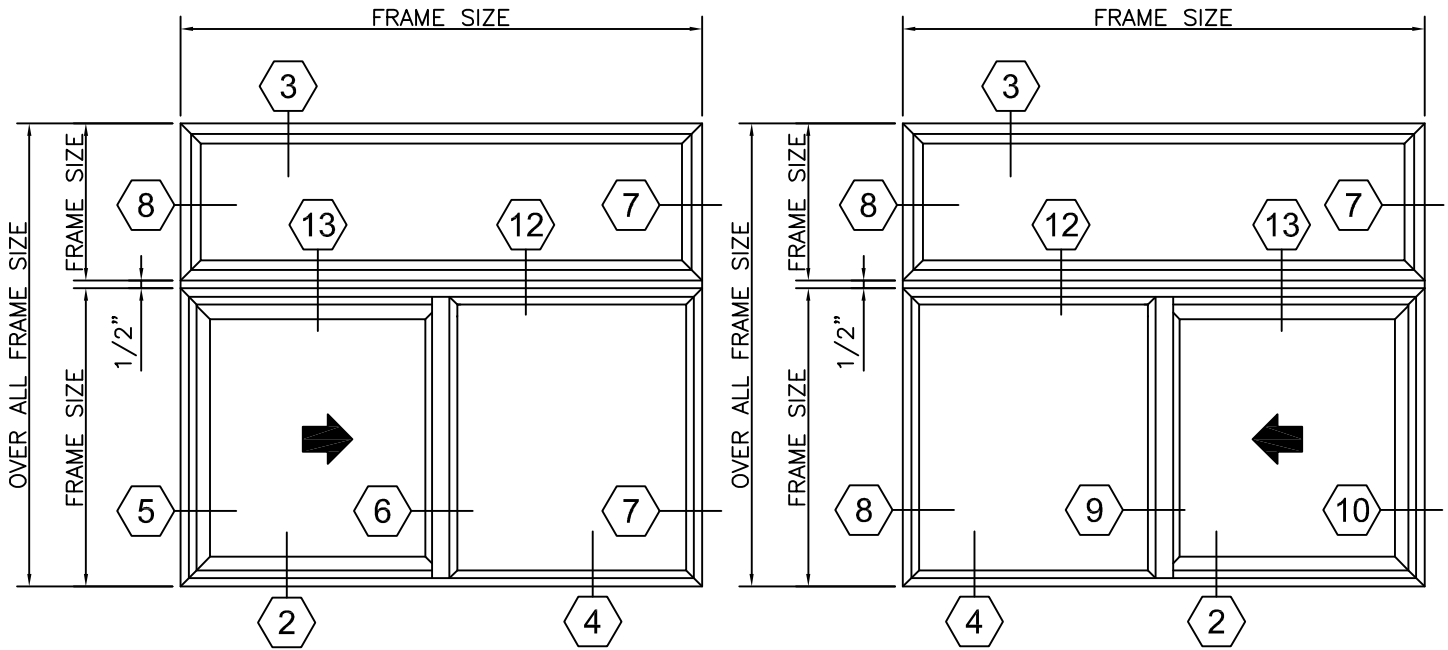

TYPE: S70	QTY:
	ARCH MK:
PRODUCT: FIXED VINYL XO SLIDER	

TYPE: S70	QTY:
	ARCH MK:
PRODUCT: FIXED VINYL OX SLIDER	

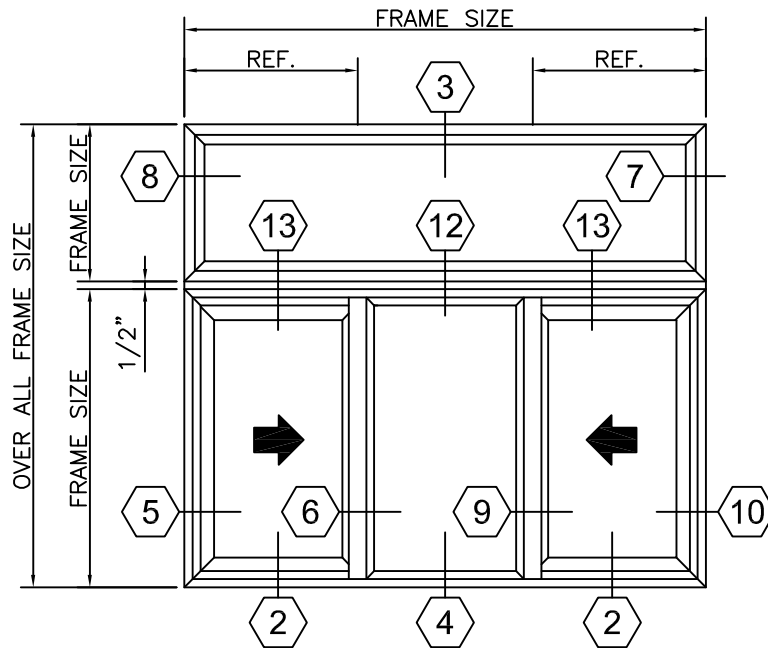

TYPE: S70	QTY:
	ARCH MK:
PRODUCT: FIXED VINYL XOX SLIDER	

FULL SCALE DETAILS

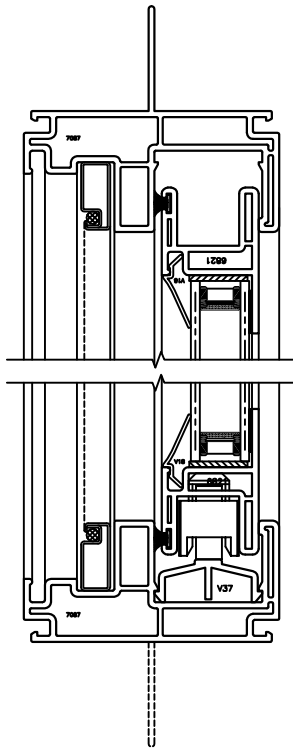

1 SASH HEAD
SERIES 70 SLIDER

2 SASH SILL
SERIES 70 SLIDER

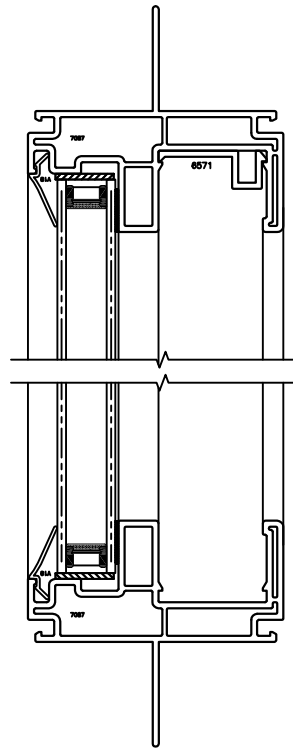

SERIES 70 SLIDER

3 FIXED HEAD
SERIES 70 SLIDER

4 FIXED SILL
SERIES 70 SLIDER

5 SASH JAMB
SERIES 70 SLIDER

6 MTG RAIL
SERIES 70 SLIDER

7 FIXED JAMB
SERIES 70 SLIDER

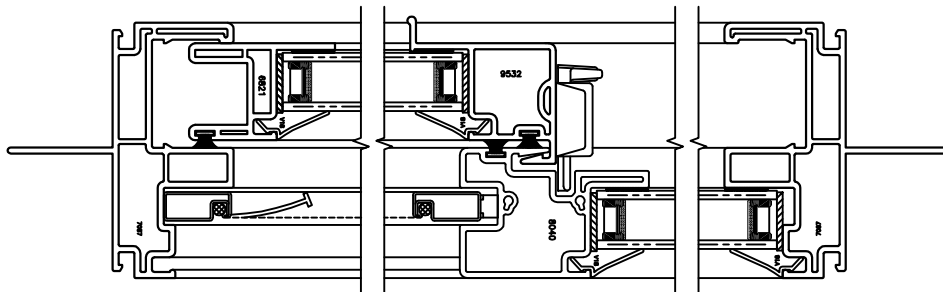

FULL SCALE DETAILS

8 SASH JAMB
SERIES 70 SLIDER

9 MTG RAIL
SERIES 70 SLIDER

10 FIXED JAMB
SERIES 70 SLIDER

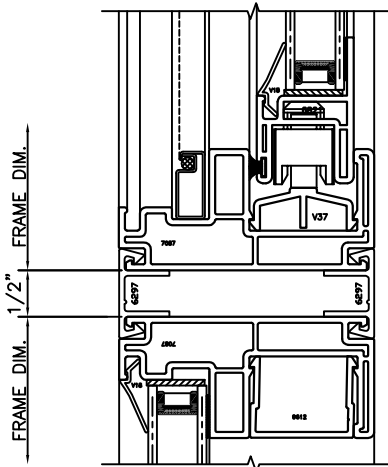
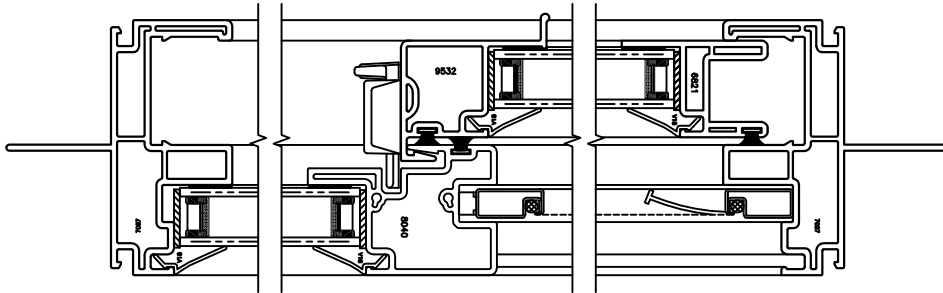

11 MULL STRIP
SERIES 70
SASH/FIXED

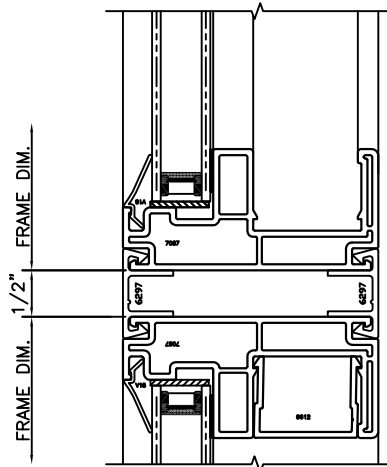

12 MULL STRIP
SERIES 70
FIXED/FIXED

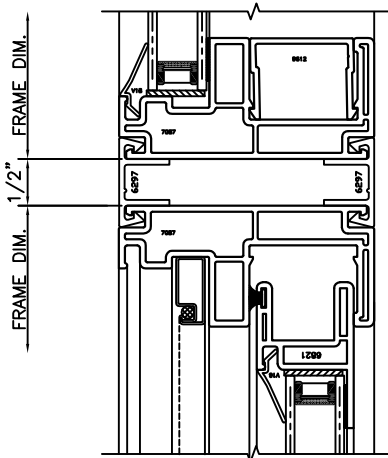

13 MULL STRIP
SERIES 70
FIXED/SASH

FULL SCALE DETAILS